

# NOW LEASING Tillamook **Fred Meyer** Shops

Tillamook, Oregon

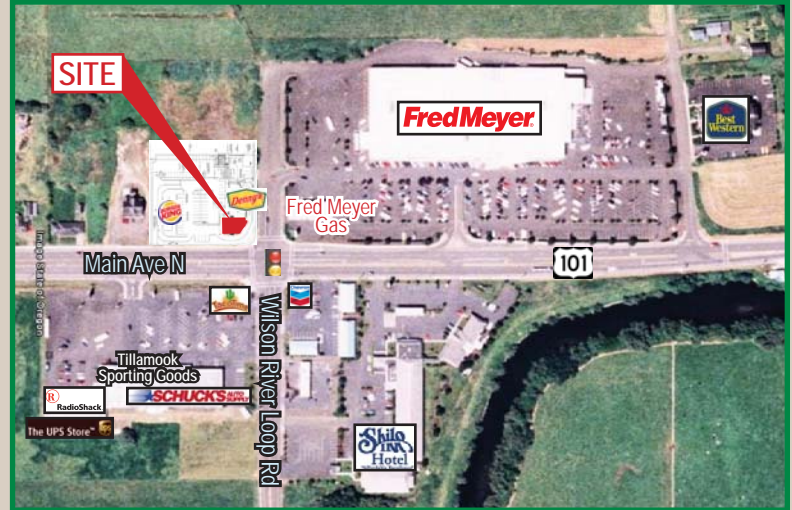

**Location:** Hwy 101 & Wilson River Loop Rd, Tillamook, Oregon

**Available Space:** 1850 SF End-Cap Drive-Thru

**Rates:** Mid \$20's - Call for details

**Traffic Counts:** US Hwy 101/N Main Ave – 16,000 ADT (09)

### Comments:

- Most identifiable and convenient site in the growing regional Tillamook trade area
- Co-tenant with new Denny's and Burger King
- Very visible on State Hwy 101 (highest traffic counts) at full signalized intersection with Wilson River Loop Road which connects east to State Hwy 8
- Front and rear signage + pylon signage
- Convenient access at Fred Meyer main entry



### Demographics:

#### Tillamook County

Population 2010	24,901
2010 Average HH Income	\$49,074
Employees	11,049

Source: Regis - SitesUSA



**Jeff Olson**

jeff@cra-nw.com

(503) 274-0211 x 160

Commercial Realty Advisors NW, LLC  
733 S.W. 2nd Avenue, Suite 200  
Portland, Oregon 97204  
www.cra-nw.com

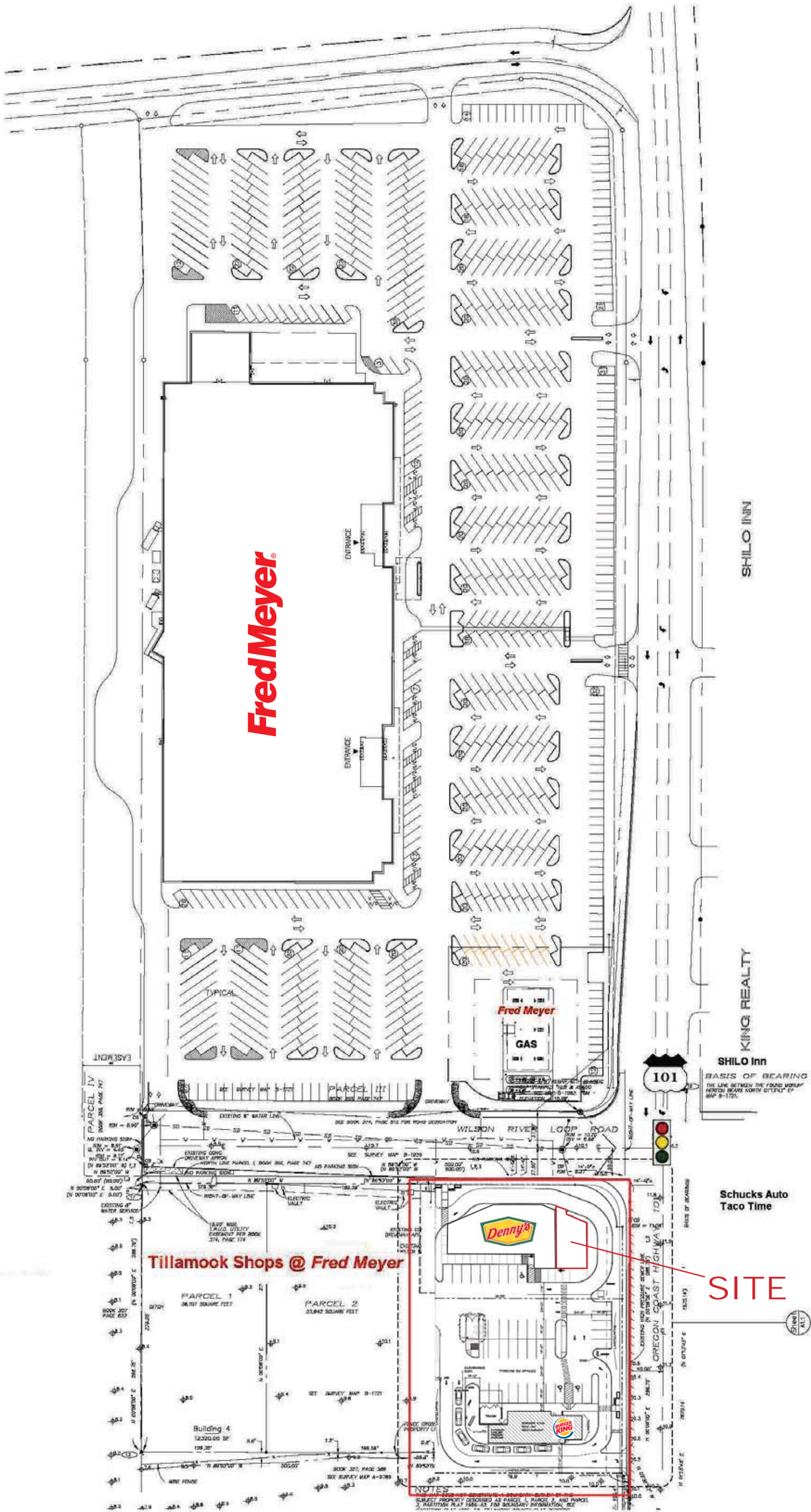

**Fred Meyer**

**Fred Meyer**

**GAS**



**SITE**

**Tillamook Shops @ Fred Meyer**

**Schucks Auto Taco Time**

**SHILO Inn**  
BASIS OF BEARING  
THE LINE BETWEEN THE FOOD MARKET  
SECTION BEARS NORTH 01°15'12" E  
MAP 9-1721.

**SHILO KING REALTY**

**NOTES**  
SUBJECT PROPERTY DESCRIBED AS PARCEL 1, PARCEL 2, AND PARCEL 3, PARTITION PLAT 1555-43 FOR BOUNDARY INFORMATION, REC. 01/15/2014 AT 10:00 AM.

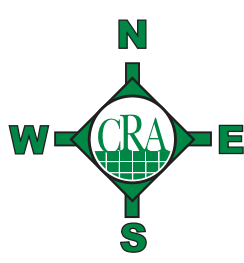

SITE

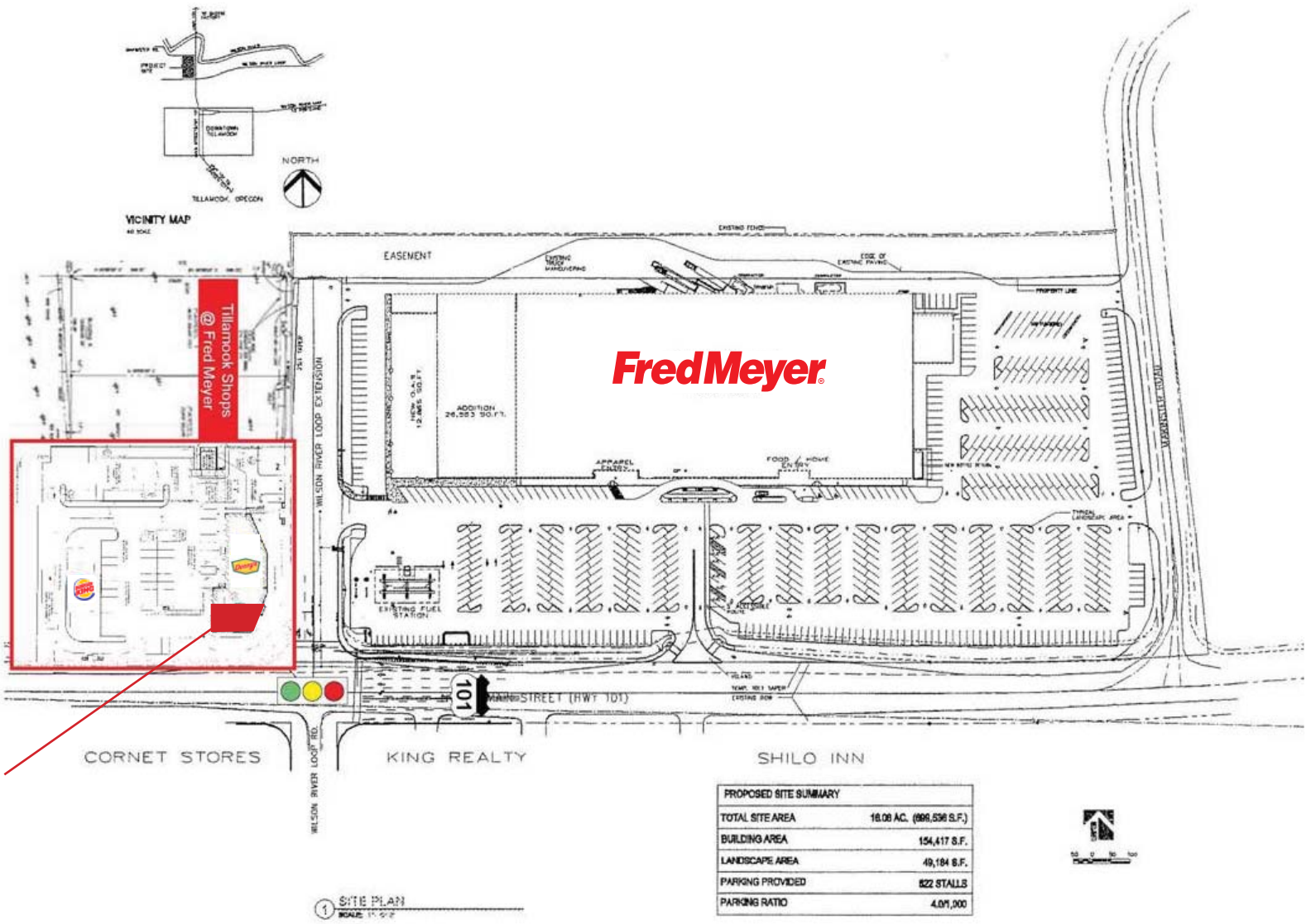

Fred Meyer



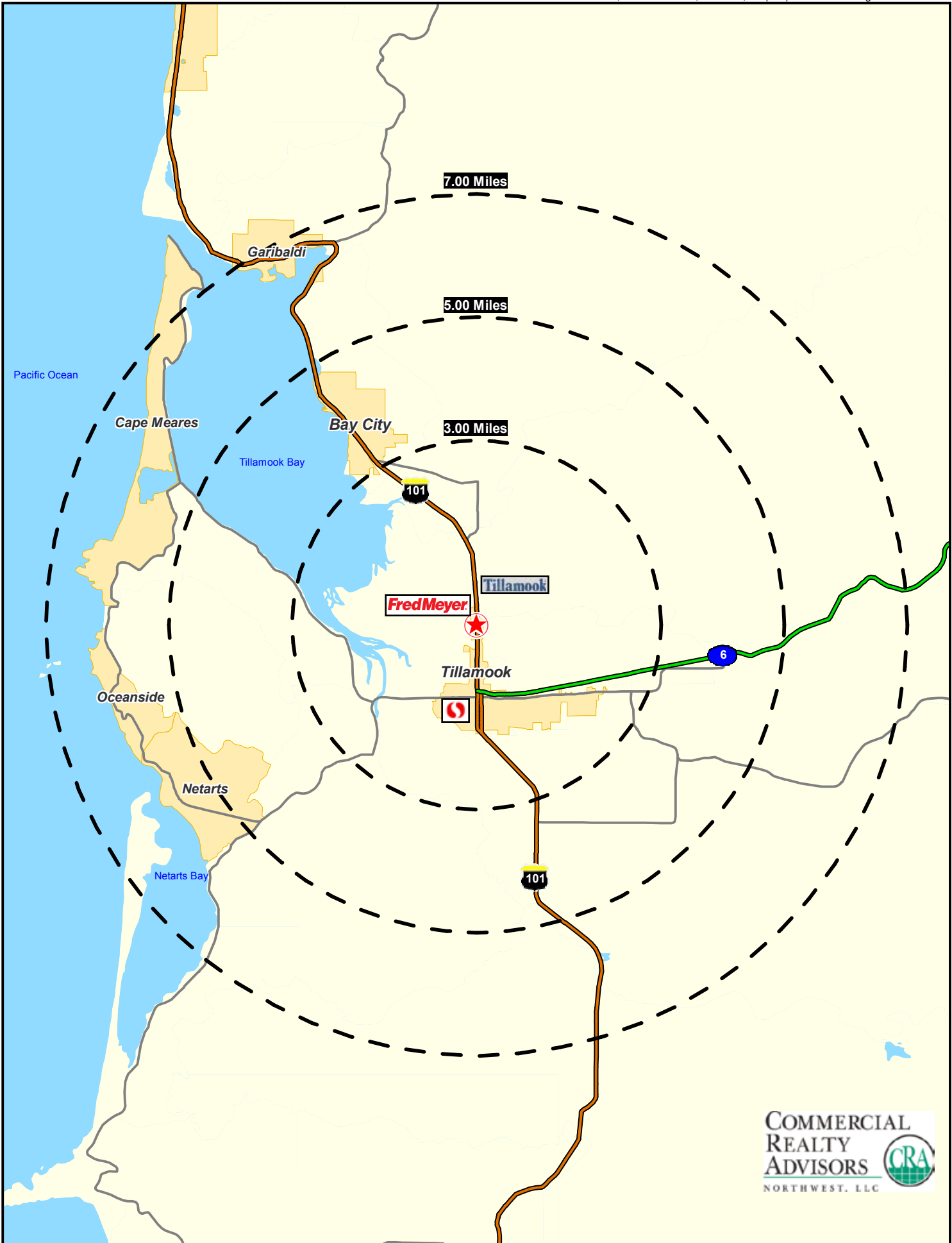

# FULL PROFILE

1990 - 2000 Census, 2010 Estimates with 2015 Projections  
 Calculated using Proportional Block Groups



Lat/Lon: 45.45645/-123.7588

## Tillamook

<b>POPULATION</b>	2010 Estimated Population	24,901
	2015 Projected Population	24,813
	2000 Census Population	24,262
	1990 Census Population	21,570
	Historical Annual Growth 1990 to 2010	0.8%
	Projected Annual Growth 2010 to 2015	-0.1%
<b>HOUSEHOLDS</b>	2010 Est. Households	12,206
	2015 Proj. Households	13,286
	2000 Census Households	10,200
	1990 Census Households	8,845
	Historical Annual Growth 1990 to 2010	1.9%
	Projected Annual Growth 2010 to 2015	1.8%
<b>AGE</b>	2010 Est. Population 0 to 9 Years	10.9%
	2010 Est. Population 10 to 19 Years	11.0%
	2010 Est. Population 20 to 29 Years	12.0%
	2010 Est. Population 30 to 44 Years	17.0%
	2010 Est. Population 45 to 59 Years	21.5%
	2010 Est. Population 60 to 74 Years	17.9%
	2010 Est. Population 75 Years Plus	9.6%
	2010 Est. Median Age	42.7
<b>MARITAL STATUS &amp; SEX</b>	2010 Est. Male Population	50.1%
	2010 Est. Female Population	49.9%
	2010 Est. Never Married	18.5%
	2010 Est. Now Married	57.8%
	2010 Est. Separated or Divorced	15.9%
	2010 Est. Widowed	7.8%
<b>INCOME</b>	2010 Est. HH Income \$200,000 or More	1.3%
	2010 Est. HH Income \$150,000 to \$199,999	2.5%
	2010 Est. HH Income \$100,000 to \$149,999	6.4%
	2010 Est. HH Income \$75,000 to \$99,999	8.6%
	2010 Est. HH Income \$50,000 to \$74,999	13.8%
	2010 Est. HH Income \$35,000 to \$49,999	16.8%
	2010 Est. HH Income \$25,000 to \$34,999	16.2%
	2010 Est. HH Income \$15,000 to \$24,999	16.7%
	2010 Est. HH Income \$0 to \$14,999	17.6%
	2010 Est. Average Household Income	\$49,074
	2010 Est. Median HH Income	\$35,106
	2010 Est. Per Capita Income	\$24,823
	2010 Est. Number of Businesses	1,467
	2010 Est. Total Number of Employees	11,049

This report was produced using data from private and government sources deemed to be reliable. The information herein is provided without representation or warranty.

# FULL PROFILE

1990 - 2000 Census, 2010 Estimates with 2015 Projections  
 Calculated using Proportional Block Groups



Lat/Lon: 45.45645/-123.7588

## Tillamook

<b>RACE</b>	2010 Est. White Population	94.8%
	2010 Est. Black Population	0.5%
	2010 Est. Asian & Pacific Islander	1.2%
	2010 Est. American Indian & Alaska Native	1.4%
	2010 Est. Other Races Population	2.1%
<b>HISPANIC</b>	2010 Est. Hispanic Population	2,162
	2010 Est. Hispanic Population Percent	8.7%
	2015 Proj. Hispanic Population Percent	10.0%
	2000 Hispanic Population Percent	
<b>EDUCATION (Adults 25 or Older)</b>	2010 Est. Adult Population (25 Years or Older)	18,063
	2010 Est. Elementary (0 to 8)	3.8%
	2010 Est. Some High School (9 to 11)	7.1%
	2010 Est. High School Graduate (12)	36.7%
	2010 Est. Some College (13 to 16)	27.7%
	2010 Est. Associate Degree Only	6.7%
	2010 Est. Bachelor Degree Only	10.3%
	2010 Est. Graduate Degree	7.7%
<b>HOUSING</b>	2010 Est. Total Housing Units	18,528
	2010 Est. Owner Occupied Percent	42.9%
	2010 Est. Renter Occupied Percent	23.0%
	2010 Est. Vacant Housing Percent	34.1%
<b>HOMES BUILT BY YEAR</b>	2000 Homes Built 1999 to 2000	3.1%
	2000 Homes Built 1995 to 1998	9.0%
	2000 Homes Built 1990 to 1994	9.1%
	2000 Homes Built 1980 to 1989	14.6%
	2000 Homes Built 1970 to 1979	20.4%
	2000 Homes Built 1960 to 1969	10.2%
	2000 Homes Built 1950 to 1959	9.8%
	2000 Homes Built Before 1949	23.9%
<b>HOME VALUES</b>	2000 Home Value \$1,000,000 or More	0.4%
	2000 Home Value \$500,000 to \$999,999	1.4%
	2000 Home Value \$400,000 to \$499,999	2.5%
	2000 Home Value \$300,000 to \$399,999	6.0%
	2000 Home Value \$200,000 to \$299,999	16.6%
	2000 Home Value \$150,000 to \$199,999	20.0%
	2000 Home Value \$100,000 to \$149,999	27.5%
	2000 Home Value \$50,000 to \$99,999	24.1%
	2000 Home Value \$25,000 to \$49,999	1.3%
	2000 Home Value \$0 to \$24,999	0.3%
	2000 Median Home Value	\$156,367
	2000 Median Rent	\$422

This report was produced using data from private and government sources deemed to be reliable. The information herein is provided without representation or warranty.

# FULL PROFILE

1990 - 2000 Census, 2010 Estimates with 2015 Projections  
 Calculated using Proportional Block Groups



Lat/Lon: 45.45645/-123.7588

## Tillamook

<b>LABOR FORCE</b>	2010 Est. Labor: Population Age 16+	20,587
	2010 Est. Civilian Employed	51.1%
	2010 Est. Civilian Unemployed	7.4%
	2010 Est. in Armed Forces	0.2%
	2010 Est. not in Labor Force	41.4%
	2010 Labor Force: Males	49.7%
	2010 Labor Force: Females	50.3%
<b>OCCUPATION</b>	2000 Occupation: Population Age 16+	10,981
	2000 Mgmt, Business, & Financial Operations	13.0%
	2000 Professional & Related	14.2%
	2000 Service	17.3%
	2000 Sales and Office	21.8%
	2000 Farming, Fishing, and Forestry	6.5%
	2000 Construction, Extraction, & Maintenance	9.8%
	2000 Production, Transport, & Material Moving	17.3%
	2000 Percent White Collar Workers	49.1%
	2000 Percent Blue Collar Workers	50.9%
<b>TRANSPORTATION TO WORK</b>	2000 Drive to Work Alone	70.9%
	2000 Drive to Work in Carpool	14.9%
	2000 Travel to Work by Public Transportation	0.6%
	2000 Drive to Work on Motorcycle	0.1%
	2000 Walk or Bicycle to Work	5.9%
	2000 Other Means	1.2%
	2000 Work at Home	6.5%
<b>TRAVEL TIME</b>	2000 Travel to Work in 14 Minutes or Less	53.0%
	2000 Travel to Work in 15 to 29 Minutes	27.4%
	2000 Travel to Work in 30 to 59 Minutes	12.0%
	2000 Travel to Work in 60 Minutes or More	7.7%
	2000 Average Travel Time to Work	18.9
<b>CONSUMER EXPENDITURE</b>	2010 Est. Total Household Expenditure	\$526 M
	2010 Est. Apparel	\$24.9 M
	2010 Est. Contributions & Gifts	\$32.5 M
	2010 Est. Education & Reading	\$13.3 M
	2010 Est. Entertainment	\$29.0 M
	2010 Est. Food, Beverages & Tobacco	\$86.0 M
	2010 Est. Furnishings & Equipment	\$22.3 M
	2010 Est. Health Care & Insurance	\$39.7 M
	2010 Est. Household Operations & Shelter & Utilities	\$157 M
	2010 Est. Miscellaneous Expenses	\$9.04 M
	2010 Est. Personal Care	\$7.68 M
2010 Est. Transportation	\$105 M	

This report was produced using data from private and government sources deemed to be reliable. The information herein is provided without representation or warranty.