

FOR  
LEASE

# Hillsboro Plaza

Hillsboro, Oregon



**Location:** Centrally located on SE 10th & SE Baseline in Hillsboro

**Available Space:** Shop Space - 877 SF former office space; 1,800 SF former restaurant; Pad

**Rental Rate:** Shop - \$15.00/SF/YR, NNN  
Pad - Please call for rates

## Demographics

	1 Mile	3 Miles	5 Miles
Population 2010	19,229	70,913	128,011
Population Forecast 2015	22,820	79,825	142,528
2010 Average HH Income	\$56,367	\$74,762	\$70,724
Employees	9,304	25,064	45,740

Source: Regis - SitesUSA



George Macoubray | [george@cra-nw.com](mailto:george@cra-nw.com)  
Nick Stanton | [nick@cra-nw.com](mailto:nick@cra-nw.com)  
(503) 274-0211

Commercial Realty Advisors NW, LLC  
733 SW 2nd Avenue, Suite 200  
Portland, Oregon 97204  
[www.cra-nw.com](http://www.cra-nw.com)

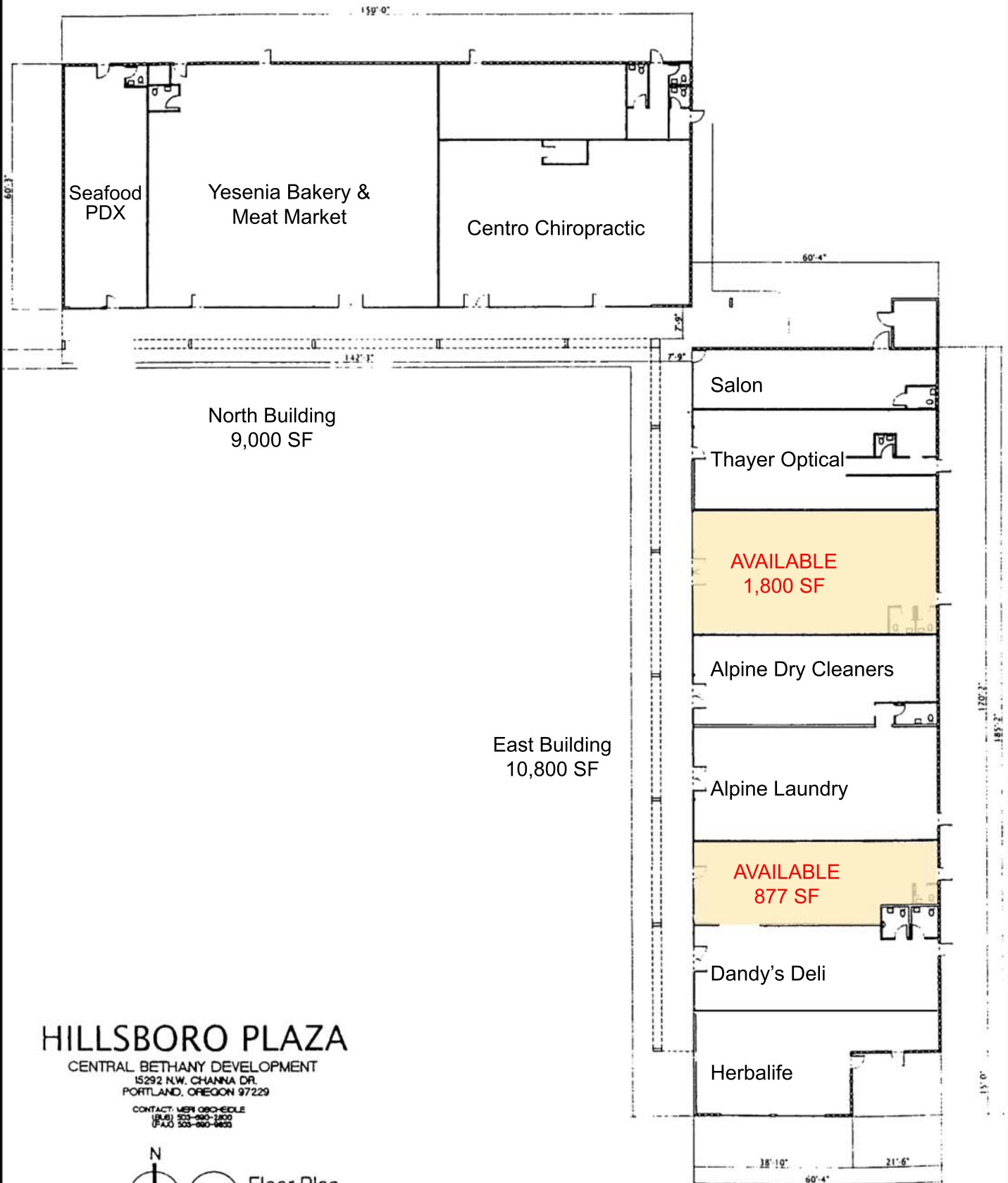

# HILLSBORO PLAZA

CENTRAL BETHANY DEVELOPMENT  
15292 N.W. CHANNA DR.  
PORTLAND, OREGON 97229

CONTACT: MERRI OSCH-EDLE  
(BUS) 503-690-2800  
(FAX) 503-690-9855



Floor Plan

1/16" = 1'-0"

Locos are for identification purposes only and may be trademarks of their respective companies.

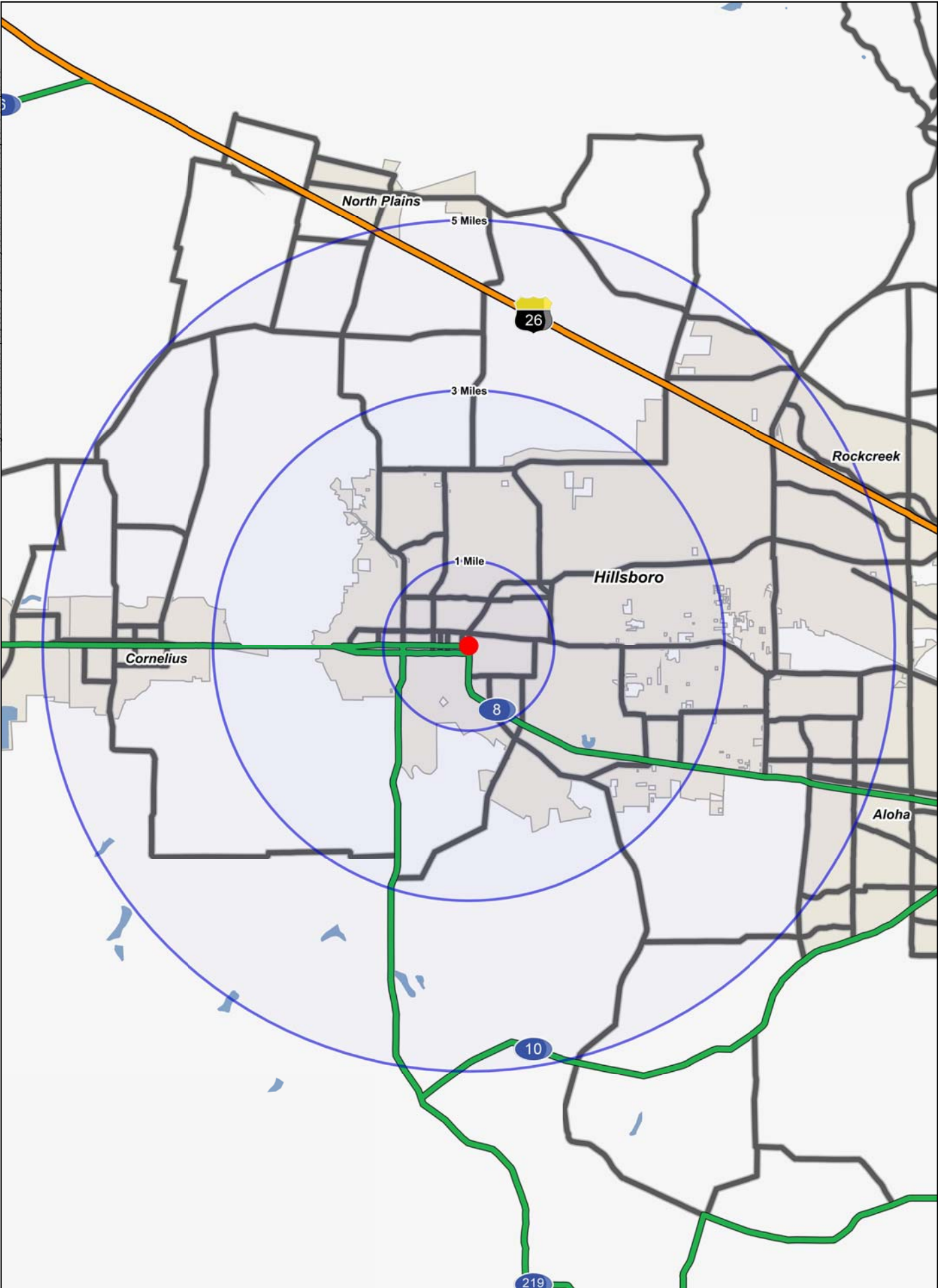

# FULL PROFILE

1990 - 2000 Census, 2010 Estimates with 2015 Projections  
 Calculated using Proportional Block Groups



Lat/Lon: 45.51997/-122.9739

## Se 10th Ave & Se Baseline St Hillsboro, OR

		1 Mile	3 Miles	5 Miles
<b>POPULATION</b>	2010 Estimated Population	19,229	70,913	128,011
	2015 Projected Population	22,820	79,825	142,528
	2000 Census Population	17,269	56,344	102,683
	1990 Census Population	14,236	39,013	64,055
	Historical Annual Growth 1990 to 2010	1.8%	4.1%	5.0%
	Projected Annual Growth 2010 to 2015	3.7%	2.5%	2.3%
<b>HOUSEHOLDS</b>	2010 Est. Households	5,615	22,825	43,633
	2015 Proj. Households	6,552	25,499	48,373
	2000 Census Households	5,182	18,544	35,787
	1990 Census Households	4,893	13,237	21,755
	Historical Annual Growth 1990 to 2010	0.7%	3.6%	5.0%
	Projected Annual Growth 2010 to 2015	3.3%	2.3%	2.2%
<b>AGE</b>	2010 Est. Population 0 to 9 Years	16.7%	16.2%	16.0%
	2010 Est. Population 10 to 19 Years	14.7%	15.0%	14.2%
	2010 Est. Population 20 to 29 Years	14.5%	12.2%	13.7%
	2010 Est. Population 30 to 44 Years	21.7%	23.2%	23.4%
	2010 Est. Population 45 to 59 Years	17.9%	19.8%	19.4%
	2010 Est. Population 60 to 74 Years	10.2%	10.4%	10.1%
	2010 Est. Population 75 Years Plus	4.3%	3.2%	3.3%
	2010 Est. Median Age	32.2	33.5	33.2
<b>MARITAL STATUS &amp; SEX</b>	2010 Est. Male Population	54.1%	51.8%	51.4%
	2010 Est. Female Population	45.9%	48.2%	48.6%
	2010 Est. Never Married	27.9%	25.0%	26.0%
	2010 Est. Now Married	49.0%	57.4%	56.5%
	2010 Est. Separated or Divorced	18.5%	13.5%	13.6%
	2010 Est. Widowed	4.6%	4.1%	3.9%
<b>INCOME</b>	2010 Est. HH Income \$200,000 or More	1.2%	2.7%	2.1%
	2010 Est. HH Income \$150,000 to \$199,999	2.2%	3.3%	3.2%
	2010 Est. HH Income \$100,000 to \$149,999	9.9%	17.6%	15.5%
	2010 Est. HH Income \$75,000 to \$99,999	11.6%	15.3%	15.6%
	2010 Est. HH Income \$50,000 to \$74,999	21.0%	22.5%	24.2%
	2010 Est. HH Income \$35,000 to \$49,999	16.3%	14.6%	14.8%
	2010 Est. HH Income \$25,000 to \$34,999	12.4%	8.9%	8.8%
	2010 Est. HH Income \$15,000 to \$24,999	10.3%	7.1%	7.9%
	2010 Est. HH Income \$0 to \$14,999	15.1%	7.9%	7.7%
	2010 Est. Average Household Income	\$56,367	\$74,762	\$70,724
	2010 Est. Median HH Income	\$46,622	\$63,723	\$60,736
	2010 Est. Per Capita Income	\$18,395	\$24,792	\$24,670
	2010 Est. Number of Businesses	907	2,117	3,695
	2010 Est. Total Number of Employees	9,304	25,064	45,740

This report was produced using data from private and government sources deemed to be reliable. The information herein is provided without representation or warranty.

# FULL PROFILE

1990 - 2000 Census, 2010 Estimates with 2015 Projections  
 Calculated using Proportional Block Groups



Lat/Lon: 45.51997/-122.9739

## Se 10th Ave & Se Baseline St

### Hillsboro, OR

	1 Mile	3 Miles	5 Miles	
<b>RACE</b>	2010 Est. White Population	85.3%	87.5%	84.6%
	2010 Est. Black Population	2.2%	1.8%	2.1%
	2010 Est. Asian & Pacific Islander	3.3%	5.4%	8.5%
	2010 Est. American Indian & Alaska Native	1.4%	1.0%	1.0%
	2010 Est. Other Races Population	7.8%	4.2%	3.8%
<b>HISPANIC</b>	2010 Est. Hispanic Population	10,193	20,076	30,936
	2010 Est. Hispanic Population Percent	53.0%	28.3%	24.2%
	2015 Proj. Hispanic Population Percent	56.8%	31.1%	26.5%
	2000 Hispanic Population Percent			
<b>EDUCATION (Adults 25 or Older)</b>	2010 Est. Adult Population (25 Years or Older)	11,747	44,705	81,152
	2010 Est. Elementary (0 to 8)	22.9%	10.4%	8.8%
	2010 Est. Some High School (9 to 11)	9.1%	6.6%	5.8%
	2010 Est. High School Graduate (12)	23.7%	22.5%	22.7%
	2010 Est. Some College (13 to 16)	19.5%	23.0%	23.8%
	2010 Est. Associate Degree Only	5.8%	8.1%	8.7%
	2010 Est. Bachelor Degree Only	12.0%	18.9%	19.6%
	2010 Est. Graduate Degree	6.9%	10.5%	10.6%
<b>HOUSING</b>	2010 Est. Total Housing Units	5,891	24,294	47,113
	2010 Est. Owner Occupied Percent	52.1%	64.5%	59.4%
	2010 Est. Renter Occupied Percent	43.2%	29.4%	33.3%
	2010 Est. Vacant Housing Percent	4.7%	6.0%	7.4%
<b>HOMES BUILT BY YEAR</b>	2000 Homes Built 1999 to 2000	2.9%	5.2%	7.4%
	2000 Homes Built 1995 to 1998	4.9%	16.9%	23.6%
	2000 Homes Built 1990 to 1994	5.7%	13.1%	13.9%
	2000 Homes Built 1980 to 1989	11.5%	14.2%	14.0%
	2000 Homes Built 1970 to 1979	31.2%	26.6%	23.1%
	2000 Homes Built 1960 to 1969	19.3%	10.4%	7.7%
	2000 Homes Built 1950 to 1959	9.5%	5.5%	4.0%
	2000 Homes Built Before 1949	15.1%	8.1%	6.3%
<b>HOME VALUES</b>	2000 Home Value \$1,000,000 or More	0.1%	0.2%	0.1%
	2000 Home Value \$500,000 to \$999,999	0.3%	0.4%	0.4%
	2000 Home Value \$400,000 to \$499,999	0.4%	0.4%	0.5%
	2000 Home Value \$300,000 to \$399,999	2.9%	2.6%	2.7%
	2000 Home Value \$200,000 to \$299,999	12.5%	19.9%	17.8%
	2000 Home Value \$150,000 to \$199,999	29.8%	38.9%	40.5%
	2000 Home Value \$100,000 to \$149,999	47.0%	34.3%	34.7%
	2000 Home Value \$50,000 to \$99,999	6.3%	2.8%	2.8%
	2000 Home Value \$25,000 to \$49,999	0.6%	0.3%	0.3%
	2000 Home Value \$0 to \$24,999	0.1%	0.2%	0.2%
	2000 Median Home Value	\$151,035	\$168,112	\$166,307
	2000 Median Rent	\$588	\$669	\$700

This report was produced using data from private and government sources deemed to be reliable. The information herein is provided without representation or warranty.

# FULL PROFILE

1990 - 2000 Census, 2010 Estimates with 2015 Projections  
 Calculated using Proportional Block Groups



Lat/Lon: 45.51997/-122.9739

## Se 10th Ave & Se Baseline St

### Hillsboro, OR

		1 Mile	3 Miles	5 Miles
<b>LABOR FORCE</b>	2010 Est. Labor: Population Age 16+	14,415	52,934	96,481
	2010 Est. Civilian Employed	56.1%	61.0%	62.6%
	2010 Est. Civilian Unemployed	12.3%	10.4%	10.0%
	2010 Est. in Armed Forces	0.1%	0.1%	0.1%
	2010 Est. not in Labor Force	31.5%	28.6%	27.3%
	2010 Labor Force: Males	54.4%	51.9%	51.3%
	2010 Labor Force: Females	45.6%	48.1%	48.7%
<b>OCCUPATION</b>	2000 Occupation: Population Age 16+	7,827	27,778	52,960
	2000 Mgmt, Business, & Financial Operations	8.4%	11.7%	12.5%
	2000 Professional & Related	15.0%	22.2%	22.5%
	2000 Service	19.6%	14.5%	13.2%
	2000 Sales and Office	20.5%	23.8%	25.3%
	2000 Farming, Fishing, and Forestry	7.2%	2.7%	2.2%
	2000 Construction, Extraction, & Maintenance	10.2%	9.3%	9.3%
	2000 Production, Transport, & Material Moving	19.1%	15.7%	15.1%
	2000 Percent White Collar Workers	43.9%	57.8%	60.2%
	2000 Percent Blue Collar Workers	56.1%	42.2%	39.8%
<b>TRANSPORTATION TO WORK</b>	2000 Drive to Work Alone	60.0%	73.2%	73.9%
	2000 Drive to Work in Carpool	23.7%	14.8%	13.2%
	2000 Travel to Work by Public Transportation	9.0%	5.7%	6.2%
	2000 Drive to Work on Motorcycle	0.3%	0.1%	0.2%
	2000 Walk or Bicycle to Work	3.8%	2.5%	2.4%
	2000 Other Means	0.9%	0.7%	0.8%
	2000 Work at Home	2.4%	3.0%	3.3%
<b>TRAVEL TIME</b>	2000 Travel to Work in 14 Minutes or Less	27.1%	32.9%	31.2%
	2000 Travel to Work in 15 to 29 Minutes	32.5%	32.9%	34.6%
	2000 Travel to Work in 30 to 59 Minutes	31.0%	27.5%	27.9%
	2000 Travel to Work in 60 Minutes or More	9.4%	6.8%	6.2%
	2000 Average Travel Time to Work	24.1	22.9	23.2
<b>CONSUMER EXPENDITURE</b>	2010 Est. Total Household Expenditure	\$266 M	\$1.31 B	\$2.41 B
	2010 Est. Apparel	\$12.8 M	\$63.0 M	\$116 M
	2010 Est. Contributions & Gifts	\$15.7 M	\$81.6 M	\$149 M
	2010 Est. Education & Reading	\$6.94 M	\$35.8 M	\$64.9 M
	2010 Est. Entertainment	\$14.7 M	\$73.5 M	\$135 M
	2010 Est. Food, Beverages & Tobacco	\$43.5 M	\$209 M	\$386 M
	2010 Est. Furnishings & Equipment	\$11.3 M	\$58.3 M	\$107 M
	2010 Est. Health Care & Insurance	\$19.1 M	\$92.2 M	\$171 M
	2010 Est. Household Operations & Shelter & Utilities	\$79.4 M	\$392 M	\$719 M
	2010 Est. Miscellaneous Expenses	\$4.48 M	\$21.8 M	\$40.3 M
	2010 Est. Personal Care	\$3.88 M	\$19.0 M	\$35.1 M
	2010 Est. Transportation	\$53.6 M	\$266 M	\$491 M

This report was produced using data from private and government sources deemed to be reliable. The information herein is provided without representation or warranty.